

# IH-01-50 IEPE Instrumented Impact Hammer

Measuring range 50N



The IH-01-50 impact hammer belongs to a range of general-purpose hammers used for structural health testing, resonance determination and modal analysis, the IH-01-50 itself being suitable for testing of lightweight structures such as PCBs.

Included within the hammer is a piezoelectric IEPE force sensor in which directly outputs a voltage signal.

Each hammer is supplied as a kit including a cable and a variety of tips able to suit a variety of testing requirements, the IH-01-50 terminating with a M5 microdot connector.

Impact pulse width and frequency response is different with different hammer heads and tips.

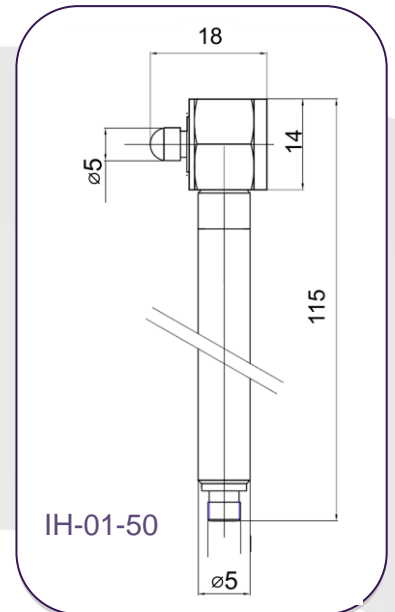

IH-01-50	Metric	Imperial
Sensitivity ( $\pm 10\%$ )	100mV/N	446mV/lbf
Measuring Range	50N	11.24lbf
Non-linearity	$\leq 1\%$	
Resolution	2mN(rms)	
Resonant Frequency	$\geq 70\text{kHz}$	
Low Frequency	1Hz	
Hammer head Weight	15gm	0.53oz
Hammer weight (total)	80g	2.82oz
Hammer Head $\varnothing$	14mm	0.55in
Hammer Length	115mm	4.53in
Output Connector	M5	
Tips Supplied	Rubber, nylon, aluminum, steel	
Excitation voltage	+18 to +28V	
Constant Current	2-10mA	
Bias Voltage	10-14VDC	
Output Impedance	$\leq 100\Omega$	

## Options

- IH-01-50 50N
- IH-01 200N
- IH-02 2000N
- IH-05 5000N
- IH-10 10000N
- IH-20 20000N
- IH-50 50000N

Other options include a wide range of accelerometers and cabling to suit any type of structural test.

## Typical Frequency Response

Pulse width and frequency response vary with hammerhead materials.

This drawing is for reference.

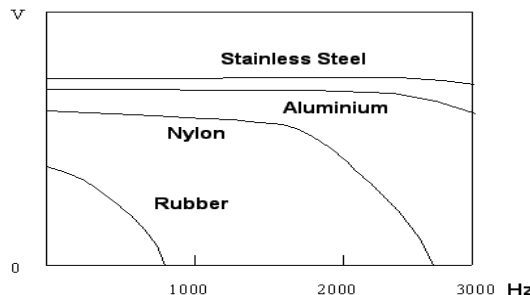

## Tips included



**Please note: For information and reference only. Data should not be used as pass/fail criteria for calibration purposes.**

**DJB Instruments (UK) Ltd**  
Finchley Avenue,  
Mildenhall, Suffolk IP28 7BG

**Tel** +44 (0)1638 712 288  
**Email** sales@djbinstruments.com  
**Web** www.djbinstruments.com

DJB Iss5.2025

A UK company with UK-based manufacturing, assembly and calibration in-house.



ISO 9001 – 00025363